

**Welcome to Fulham Palace House and Garden, the home of the Bishops of London since AD 704, and a longer history stretching back 6,000 years. Our site includes our historic house and garden, museum and café; we invite you to explore.**

Open daily • Free entry  
Wheelchair and pushchair friendly  
All ages are welcome to explore our site

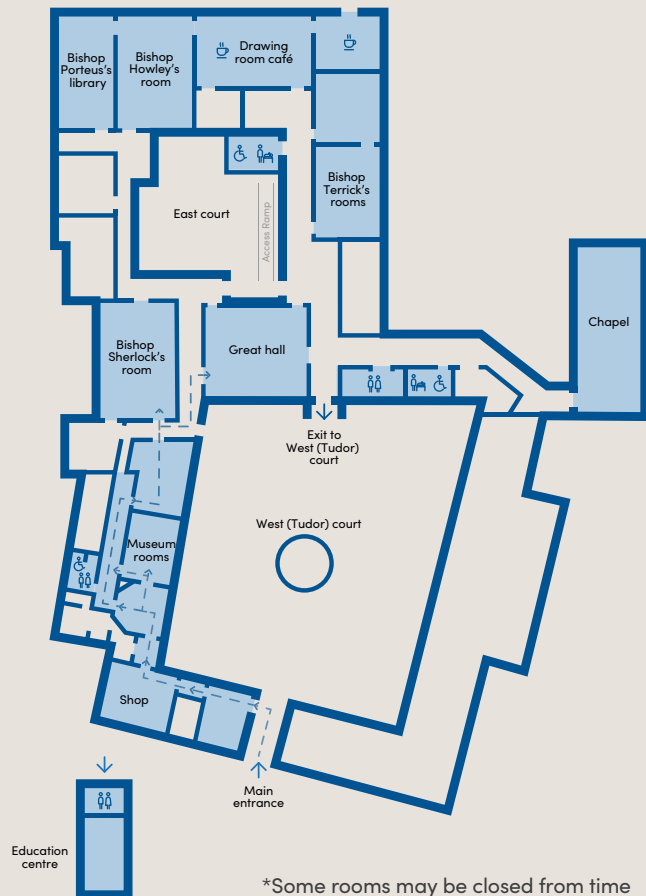

\*Some rooms may be closed from time to time for private events and functions

**Pick up our What's On guide to find out about upcoming events**

**We would love to see your photos!**

f /fulhampalacetrust  
@fulham\_palace  
@fulhampalace

### Getting here

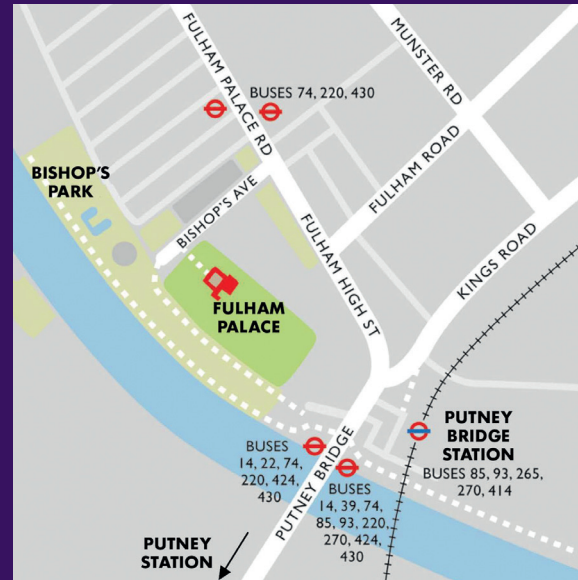

### Putney Bridge ⇌ Putney

Fulham Palace is located on Bishop's Avenue, just off Fulham Palace Road (A219). Visit our website for further information on getting to Fulham Palace including coach access and street parking.

### Accessibility

Public areas of Fulham Palace are accessible and assistance dogs are welcome. Limited accessible parking is available to book. Visit our website for further information.

Fulham Palace Trust  
Bishop's Avenue  
Fulham  
London, SW6 6EA  
+44 (0)20 7736 3233  
mail@fulhampalace.org  
Registered charity number 1140088



**Fulham Palace House & Garden**



**Visitor information and site map**

Open daily • Free admission  
[fulhampalace.org](http://fulhampalace.org)



# Home to a history that never stands still



## Walled garden

Explore the knot garden, orchard and bee hives.



## The great hall

Queen Elizabeth I attended a feast in this hall in 1601.



## Tudor courtyard

Discover the oldest part of the Palace.



## Market barrow

Buy fresh, organic produce grown in our garden.



## Café









Enjoy fresh and seasonal treats in the drawing room café.



## The chapel

Admire the wall paintings and intricate Victorian mosaics.



-  Entrance
-  Entrance to the museum
-  The education centre
-  500 year old holm oak
-  Bishop Compton planting beds
-  Bee boles
-  Garden exit
-  Natural play area

Entrance from  
Bishop's Avenue